

ORDINANCE NO. 18-2383

An ordinance to alter, rearrange and extend the corporate limits of the City of Hoover, Alabama, so as to embrace and include within the corporate limits of said City all territory now within such corporate limits and also certain other territory contiguous to said City.

WHEREAS, a petition signed by Spine & Sports Properties, LLC requesting that certain territory described therein be annexed to the City of Hoover, and

WHEREAS, there is attached to the said petition a map of said territory showing its relationship to the corporate limits of the City; and

WHEREAS, this Council has determined and found that the matters set forth and alleged in the said petition are true and that it is in the public interest that said property be annexed into the City of Hoover;

NOW, THEREFORE, be it ordained by the Council of the City of Hoover as follows:

SECTION 1: That said Council hereby assents to the annexation of said territory to the City of Hoover, Alabama, and the corporate limits of the City of Hoover are hereby extended and rearranged pursuant to the provisions of Chapter 42, Article 2, Code of Alabama, 1975 (Sections 11-42-20 through 11-42-23, as amended) so as to embrace and include said territory, in addition to the territory already within its present corporate limits, within the corporate area of said City, which said territory is not within the corporate limits or municipal boundaries of another municipality and does not lie at any point more than one-half the distance between the present corporate limits or municipal boundaries of another municipality and does not lie at any point more than one-half the distance between the present corporate limits and the corporate limits of any other municipality. Said property is described in **Exhibit "A"** attached hereto and made a part hereof.

SECTION 2: The City Clerk shall file a certified copy of this ordinance containing an accurate description of said annexed territory with the Probate Judge of Jefferson County, Alabama, and publish a copy of this ordinance as required by state law.

ADOPTED this the 18th day of June, 2018.

Gene Smith, City Council President

APPROVED BY:

Mayor Frank V. Brocato

ATTESTED:



City Clerk Margie Handley

Parcel I:

A PARCEL OF LAND LOCATED IN THE SOUTHWEST 1/4 OF THE NORTHWEST 1/4 OF SAID SECTION 27, TOWNSHIP 19 SOUTH, RANGE 3 WEST BEING MORE PARTICULARLY DESCRIBE AS FOLLOWS:

BEGIN AT THE SOUTHEAST CORNER OF SAID 1/4 - 1/4 SECTION AND RUN NORTH ALONG THE EAST LINE OF SAID 1/4 - 1/4 A DISTANCE OF 68.51 FEET TO THE SOUTH BOUNDARY OF STATE OF ALABAMA HIGHWAY # 150 AND ALSO THE BEGINNING OF A NON-TANGENT CURVE TO RIGHT WITH A RADIUS OF 1285.10 FEET, A CENTRAL ANGLE OF 18°34'22" AND A CHORD OF 414.75 FEET; THENCE LEFT IN A WESTERLY DIRECTION ALONG THE SOUTH BOUNDARY OF SAID HIGHWAY AND ALONG THE ARC OF SAID CURVE A DISTANCE OF 416.57 FEET TO THE INTERSECTION WITH THE EAST BOUNDARY OF MARS HILL ROAD; THENCE TURN TO THE LEFT A SOUTHEASTERLY DIRECTION ALONG THE NORTH BOUNDARY OF SAID MARS HILL ROAD A DISTANCE OF 99.02 FEET TO THE SOUTH LINE OF SAID SOUTHWEST 1/4 OF THE NORTHWEST 1/4; THENCE TURN AN ANGLE TO THE LEFT IN A EASTERLY DIRECTION ALONG THE SOUTH LINE OF SAID 1/4 - 1/4 A DISTANCE OF 329.09 FEET TO THE POINT OF BEGINNING.

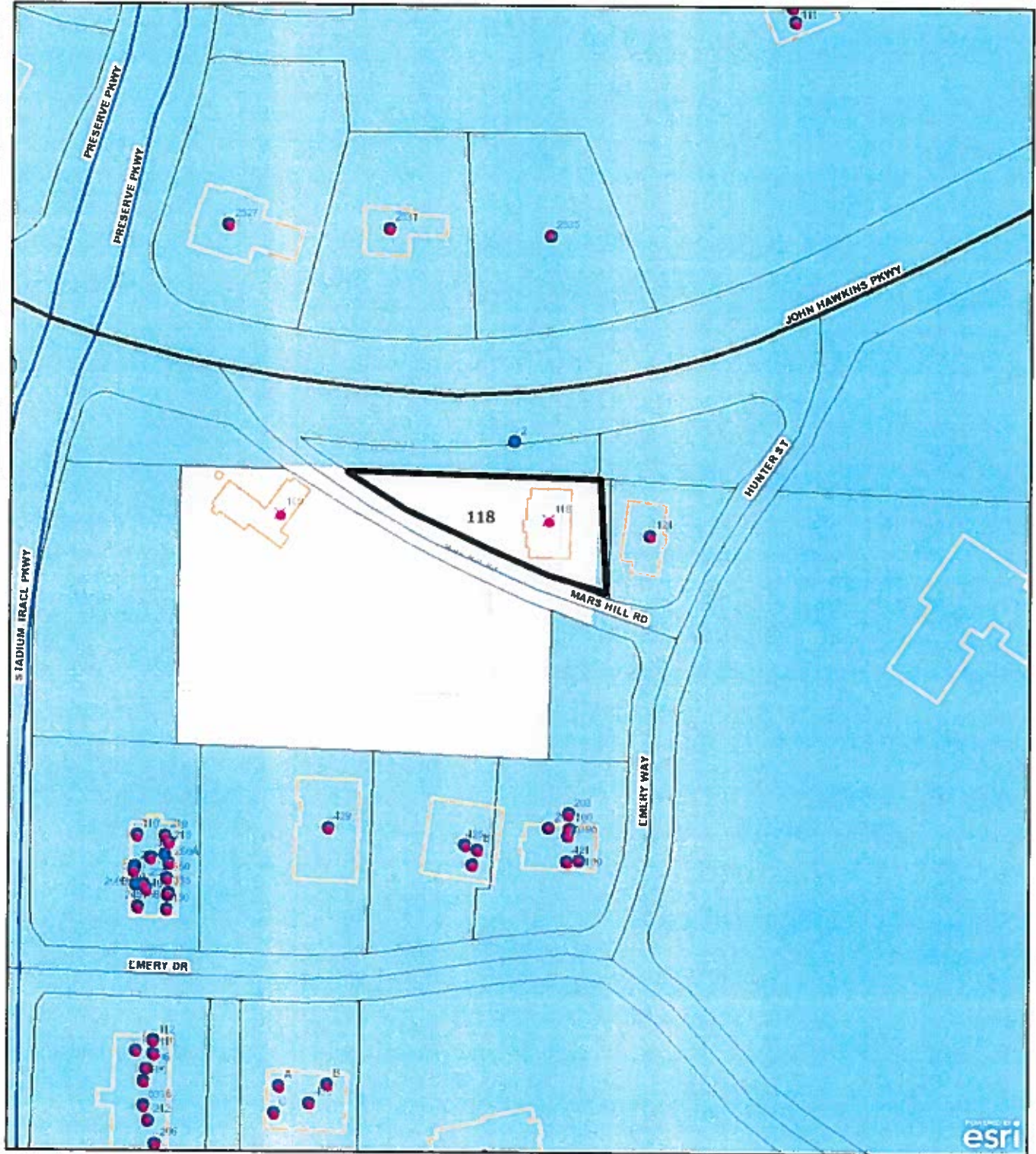
118 Mars Hill Rd



209 ft
Scale Per Inch



This City of Hoover Geographic Information System (GIS) map is used for reference purposes only. The City of Hoover does not guarantee accuracy of the material contained herein and is not responsible for misuse or



